

INFINITY • Cord Management Kit

Carefully read the contents of these instructions, as the instructions indicate the correct step by step procedure to assemble the product. The carton contents page(s) will identify the assembly part numbers and their descriptions. Before proceeding with the assembly process, match the carton contents to the stated contents to ensure there are no missing parts. In the event of assembly problems or missing parts, please call our customer service department at **616-842-5330**.

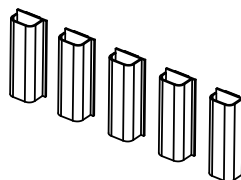
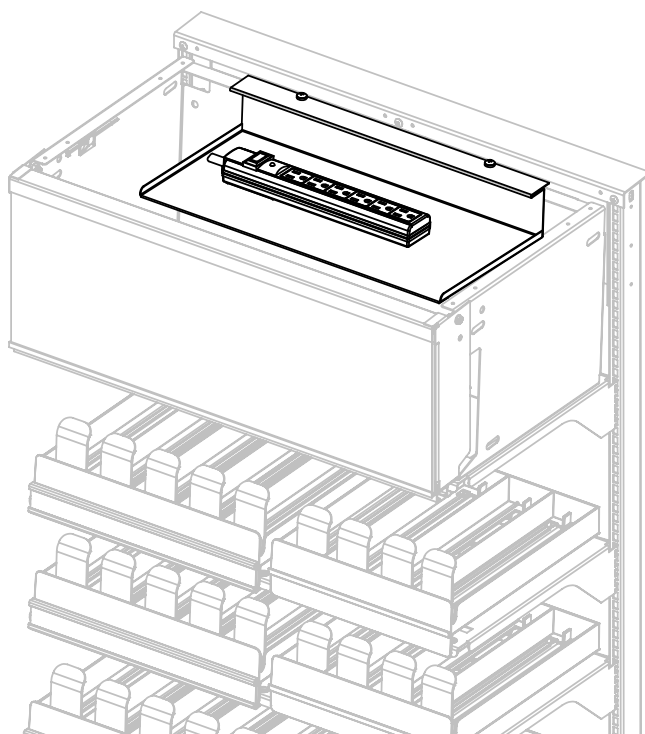

CAUTION:

ASSEMBLED UNIT IS VERY HEAVY. DO NOT ATTEMPT TO LIFT OR MOVE WITHOUT ASSISTANCE.

THE MANUFACTURER OF THIS DISPLAY ASSUMES NO LIABILITY FOR INJURY CAUSED BY IMPROPER ASSEMBLY / INSTALLATION OF THIS DISPLAY.



WARNING:

This product contains chemicals known to the State of California to cause cancer and birth defects or other reproduction harm.

For more information, go to **www.P65Warnings.ca.gov**

TOOLS

- Phillips screwdriver

Carton Contents:

Description	Qty
PLUG STRIP - 10' CORD	1
CORD MGMT TRAY	1

Hardware Kit:

#10-24 x3/4" BOLTS	2
CORD MANAGEMENT EXTRUSION	5

323663IS 08-04-2020

****IT IS THE RESPONSIBILITY OF THE INSTALLER TO CAREFULLY READ & FOLLOW ALL STEPS IN THE INSTRUCTIONS.**

INFINITY • Cord Management Kit

PLACING CORD MANAGEMENT KIT

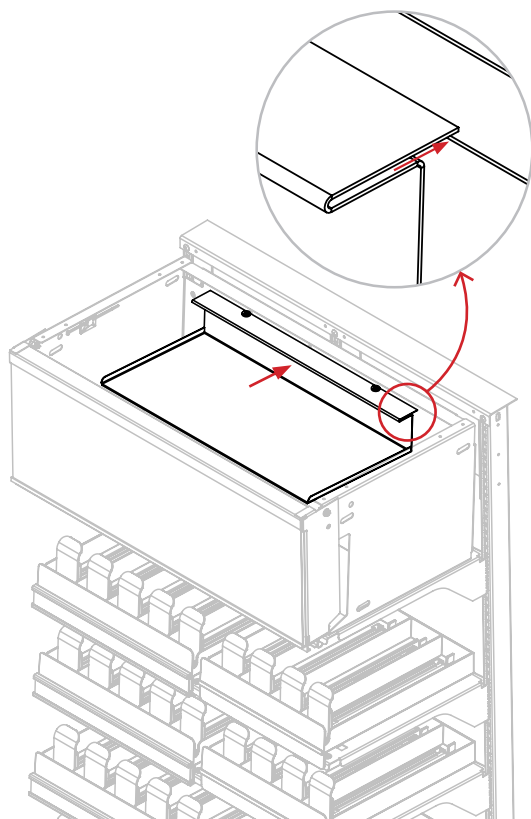

1. Place the Cord Management Tray over the back upper flange of the header. See the illustration above.

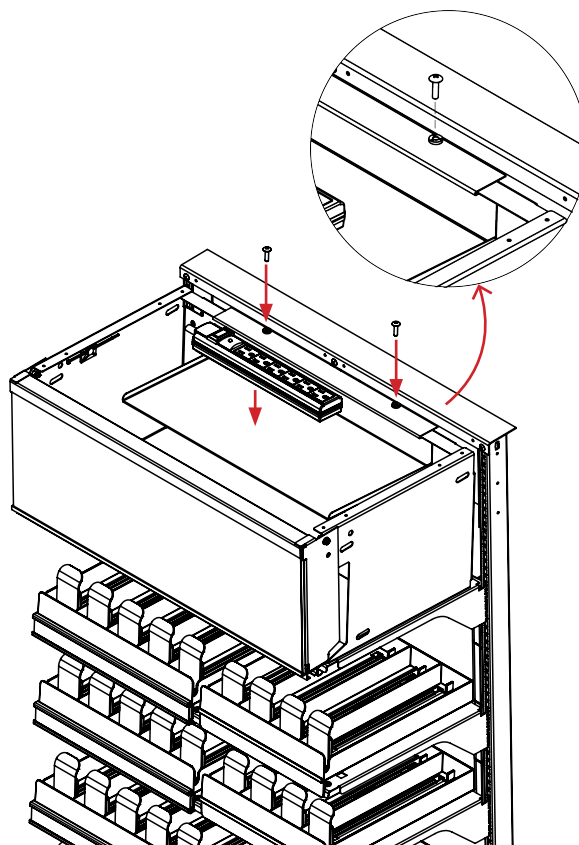

2. Secure Cord Management Tray with (2x) #10-24 X 3/4" bolts. The plug strip can then be placed on top of the tray.

Note: Make sure both bolts are fully threaded into the Cord Management Tray.

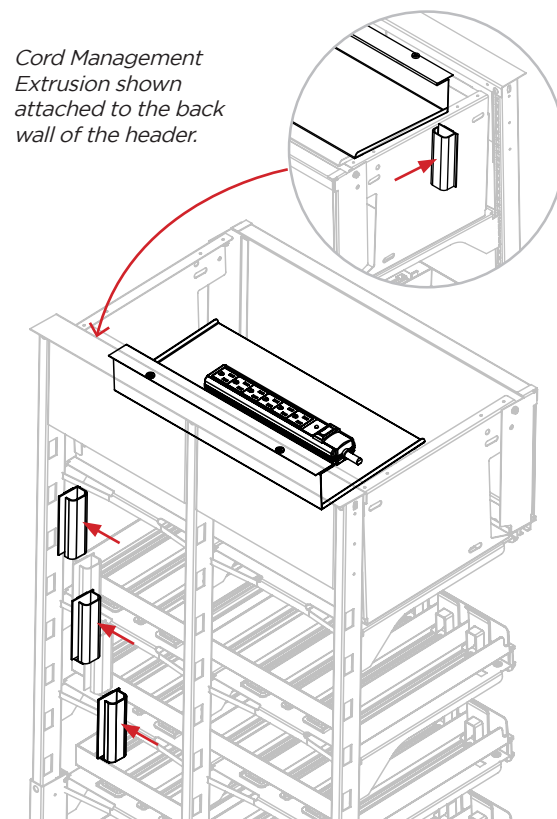

Cord Management Extrusion shown attached to the back wall of the header.

3. Peel protective backer off tape to apply Cord Management Extrusions where needed. They can be applied along the back inside areas of the uprights and to the back wall of the header areas, as shown above.

323663IS 08-04-2020

****IT IS THE RESPONSIBILITY OF THE INSTALLER TO CAREFULLY READ & FOLLOW ALL STEPS IN THE INSTRUCTIONS.**

HARBOR